

IP-5S2-RS-R40

4-Slot Backplane with 4 PCI Bus

User Manual Ver. 4.0

1. P8: AT Power Connector

Pin	Description
1	PWRGD
2	+5V
3	+12V
4	-12V
5	GND
6	GND

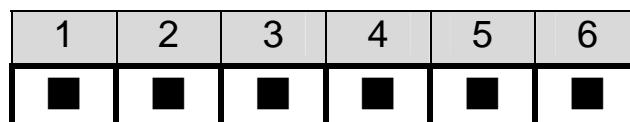

2. P9: AT Power Connector

Pin	Description
1	GND
2	GND
3	-5V
4	+5V
5	+5V
6	+5V

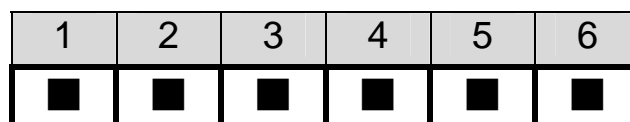

3. CN1, CN5: Fan Connector

Pin	Description
1	NC
2	+12V
3	GND

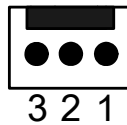

4. CN4: Voltage Connect

Pin	Description
1	+5V
2	-5V
3	-12V
4	+12V
5	GND

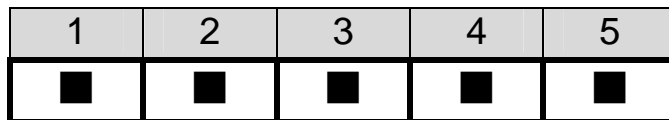

5. PCI routing table:

PCI ROUTING				
SIGNAL	PCI 1	PCI 2	PCI 3	PCI 4
REQ#	REQ0#	REQ1#	REQ2#	REQ3#
GNT#	GNT0#	GNT1#	GNT2#	GNT3#
CLOCK	CLK0	CLK1	CLK2	CLK3
IDSEL	AD19	AD20	AD21	AD22
INTA#	A	D	C	B
INTB#	B	A	D	C
INTC#	C	B	A	D
INTD#	D	C	B	A

6. Notice:

- a. Recommend to use 6mm width spacer to install

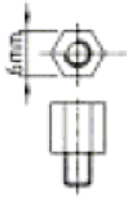

- b. Torsion must less than 6lb-inch

7. Dimension:

